

REVISIONS.

Lots 9-10 Div. Per Deed, C. Sh. 4385.
 Lots 7 & 8 Cons'd Per App. C. Sh. 8399
 LOTS 27 & 28 CONS'D PER O.O. C. SH. 722
 LOTS 1/2 & 3 PER DEED, SUB-DIV. APP. C. SH. 51-078
 LOTS 4/6 & 7/8 CONS'D PER O.O. C. SH. 98-094

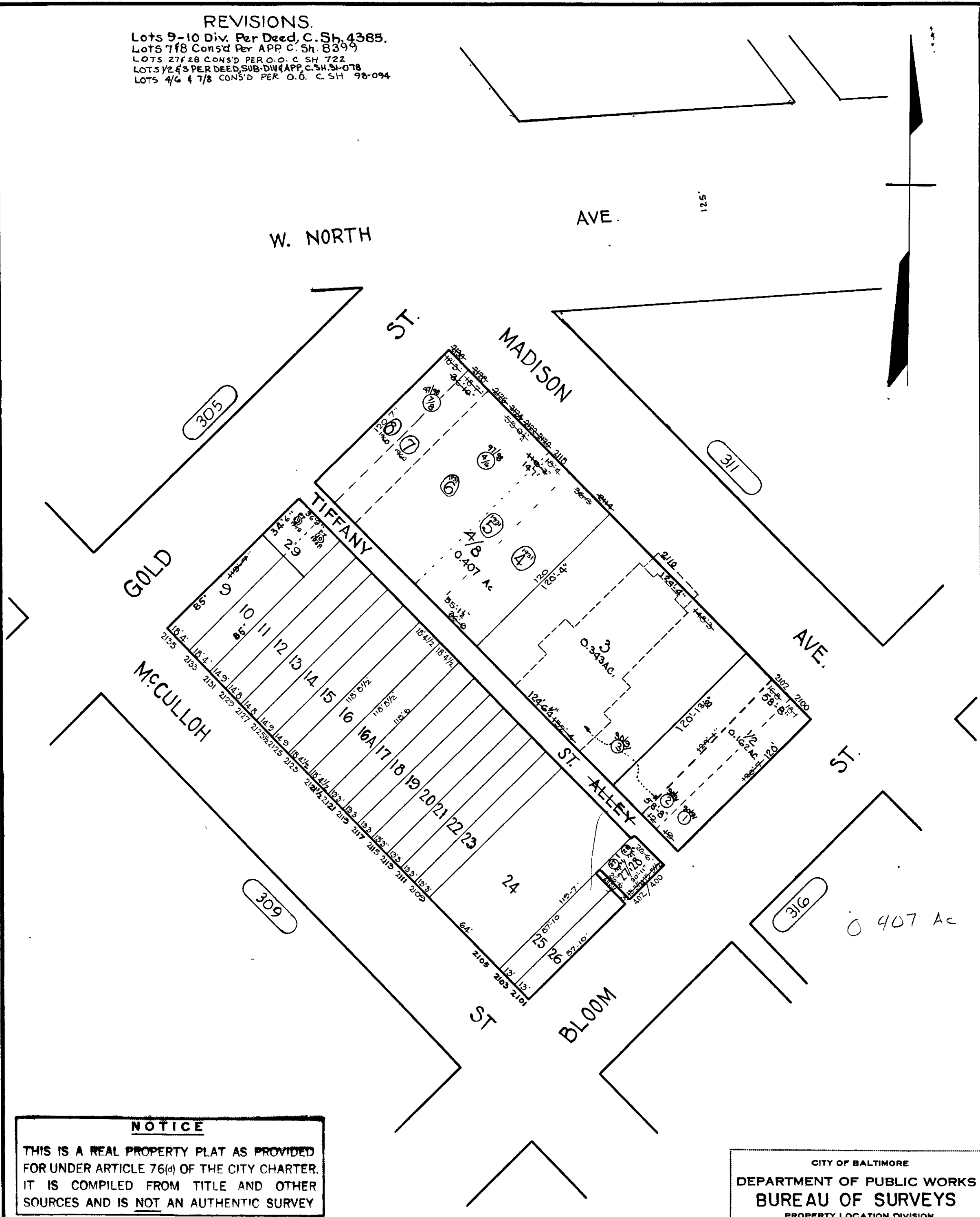

NOTICE

THIS IS A REAL PROPERTY PLAT AS PROVIDED FOR UNDER ARTICLE 76(d) OF THE CITY CHARTER. IT IS COMPILED FROM TITLE AND OTHER SOURCES AND IS NOT AN AUTHENTIC SURVEY

TRACED BY G. Moorehead

LETTERED BY W.M. Lee

CITY OF BALTIMORE
 DEPARTMENT OF PUBLIC WORKS
 BUREAU OF SURVEYS
 PROPERTY LOCATION DIVISION

WARD 14 SECTION 4
 BLOCK 310

0.407 Ac