

REVISIONS
LOT 28 PER O.O.; C.S.H. 862

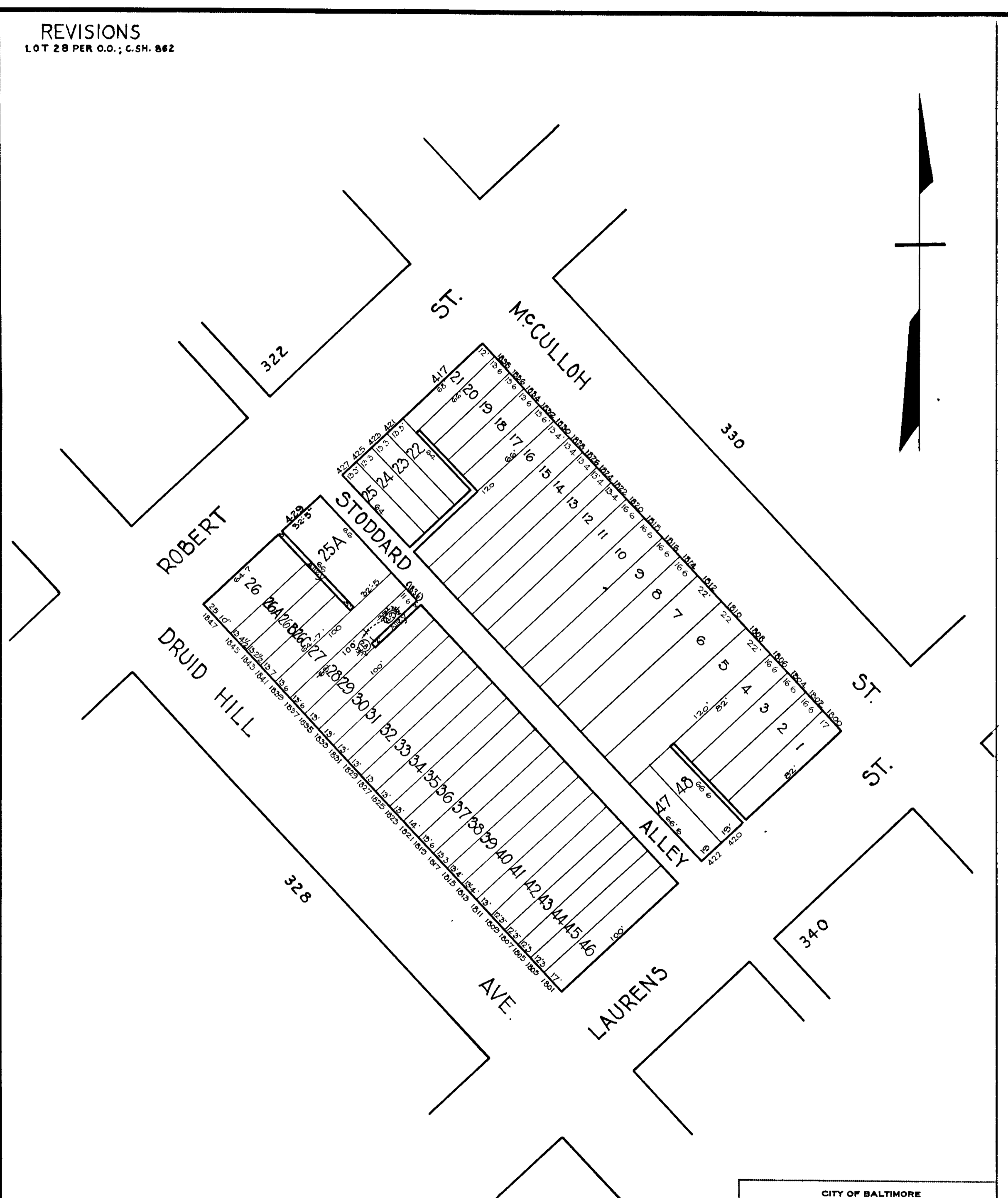

NOTICE
THIS IS A REAL PROPERTY PLAT AS PROVIDED
FOR UNDER ARTICLE 76(d) OF THE CITY CHARTER
IT IS COMPILED FROM TITLE AND OTHER
SOURCES AND IS NOT AN AUTHENTIC SURVEY

TRACED BY G. Moorehead
LETTERED BY W.M. Lee
CHECKED BY

CITY OF BALTIMORE
DEPARTMENT OF PUBLIC WORKS
BUREAU OF SURVEYS
PROPERTY LOCATION DIVISION
WARD 14 SECTION 13
BLOCK 329
SCALE 1" = 50' 0" DATE July 1929.