

-REVISIONS-

LOT 94, Desc. Cor Per P.L.S., C.S. 1076A.

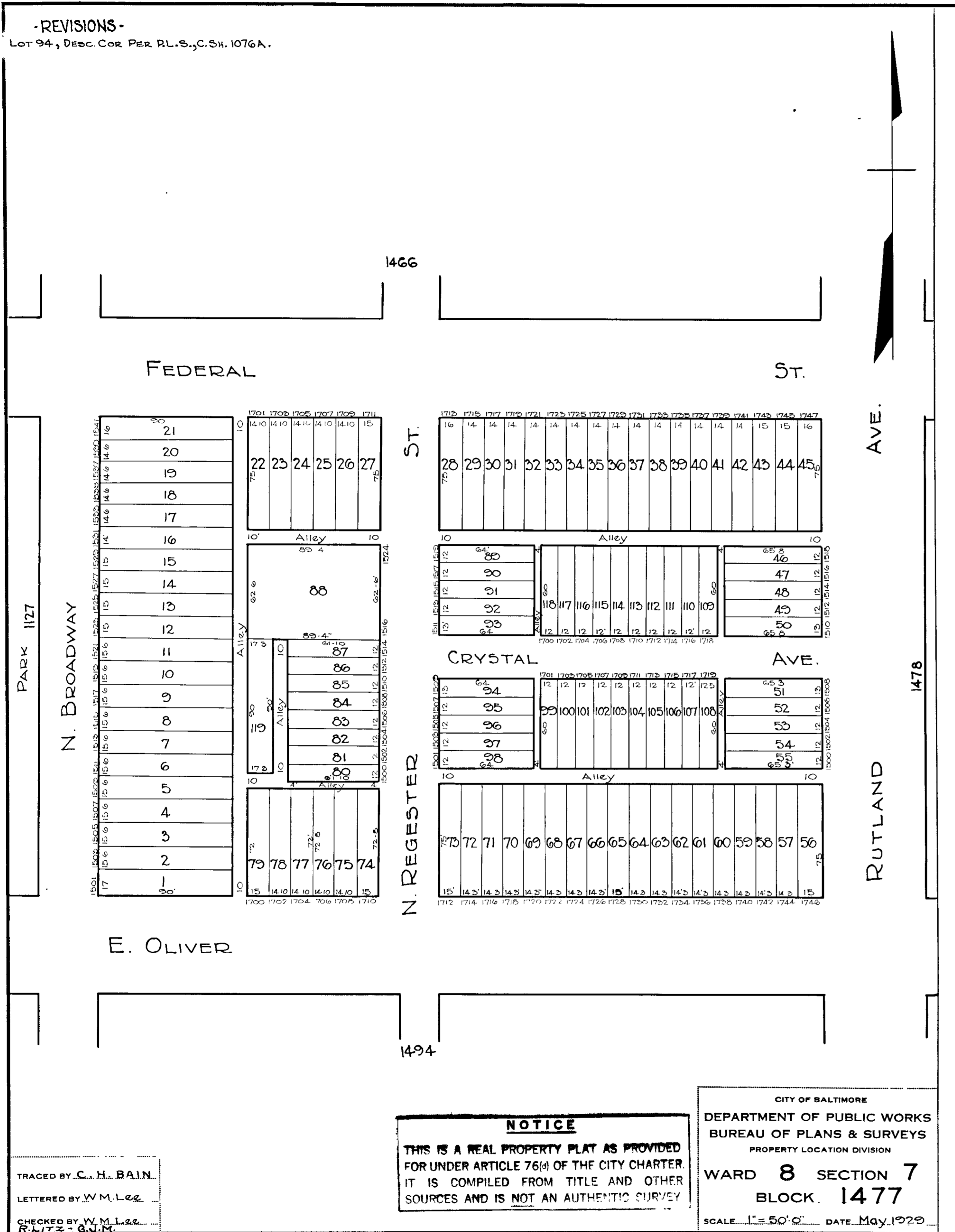

TRACED BY C. H. BALN.  
 LETTERED BY W. M. Lee.  
 CHECKED BY W. M. Lee.  
 R. LITZ - G. N. M.

**NOTICE**  
 THIS IS A REAL PROPERTY PLAT AS PROVIDED  
 FOR UNDER ARTICLE 76(4) OF THE CITY CHARTER.  
 IT IS COMPILED FROM TITLE AND OTHER  
 SOURCES AND IS NOT AN AUTHENTIC SURVEY

CITY OF BALTIMORE  
 DEPARTMENT OF PUBLIC WORKS  
 BUREAU OF PLANS & SURVEYS  
 PROPERTY LOCATION DIVISION  
 WARD 8 SECTION 7  
 BLOCK 1477  
 SCALE 1" = 50' 0" DATE May 1929