

REVISIONS

Block survey (Lee) for 1937 Sh. No 1065
 Lots 1 & 2, Consd Per App 2742 C. Sh. 4564
 LOTS 1/2 & 3 CONS'D DIV, PER DEEDS SUB-DIV C. SH 91-102

8/21/1471-1472

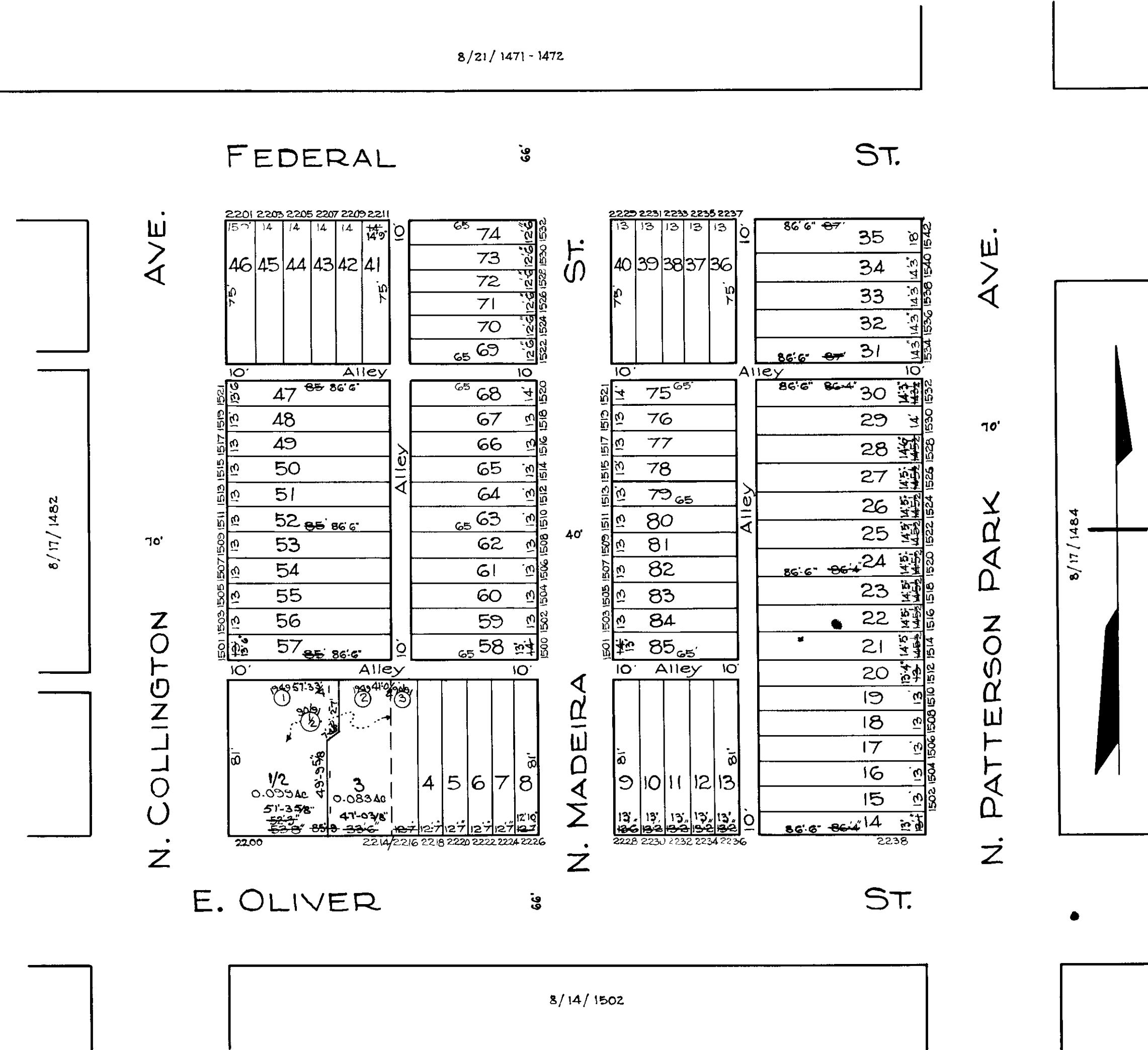

TRACED BY R. LITZ
 LETTERED BY Las. Rakosky
 CHECKED BY R. LITZ

NOTICE
 THIS IS A REAL PROPERTY PLAT AS PROVIDED
 FOR UNDER ARTICLE 76⁽¹⁾ OF THE CITY CHARTER.
 IT IS COMPILED FROM TITLE AND OTHER
 SOURCES AND IS NOT AN AUTHENTIC SURVEY.

CITY OF BALTIMORE
 DEPARTMENT OF PUBLIC WORKS
 BUREAU OF PLANS & SURVEYS
 PROPERTY LOCATION DIVISION
WARD 8 SECTION 17
BLOCK 1483
 SCALE 1 INCH = 50 FT. DATE April 1929