

REVISIONS

LOTS 24-35 & 46-114A COMED PER O.O.; CH. SH. 03-174 THRU 182
 LOTS 34/35 & 46A PER P.L.S. CH. SH. 04-258



E. PRESTON ST.

ST.

St.

N. WASHINGTON

St.

N. CHESTER

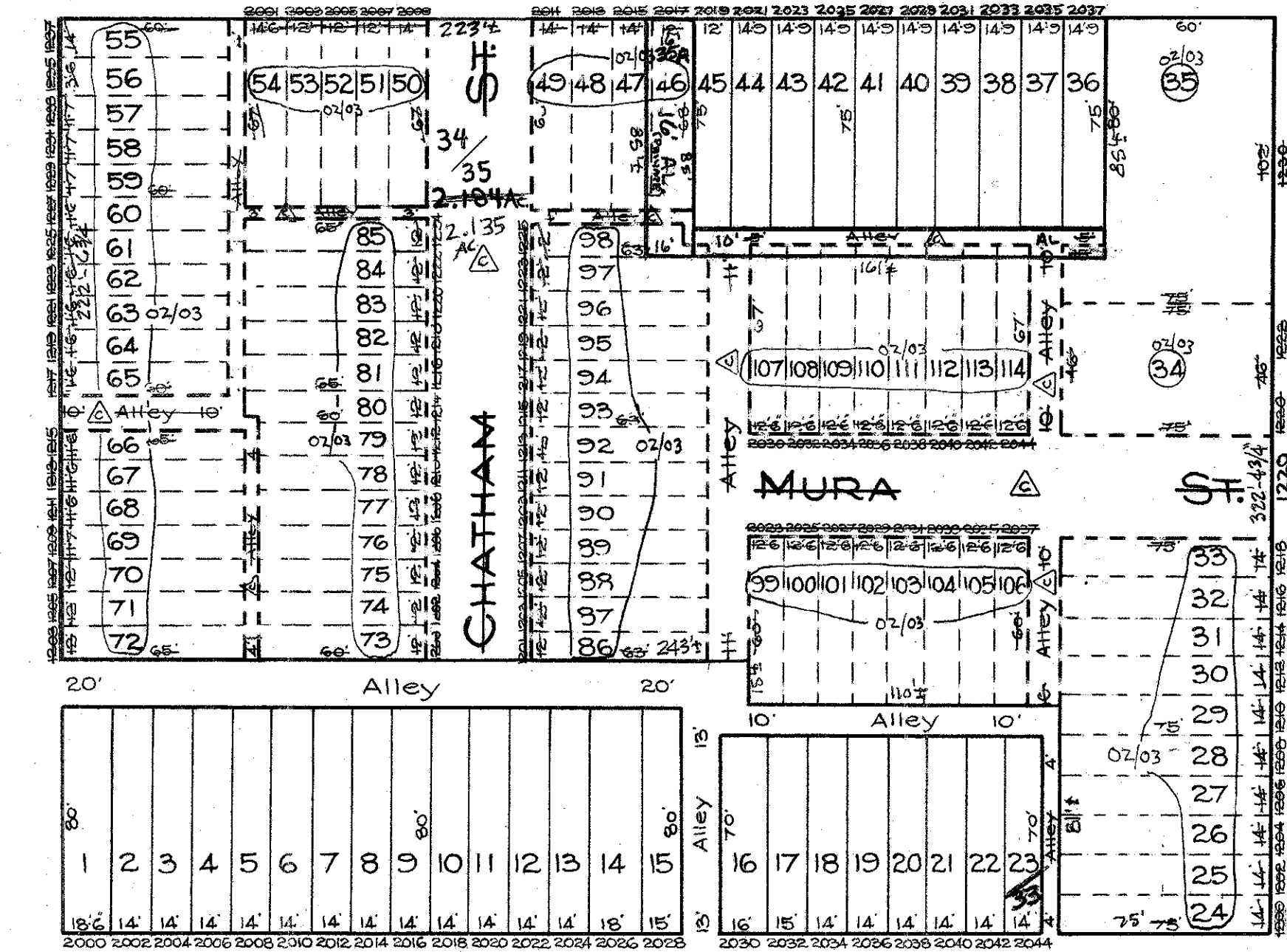

E. BIDDLE ST.

ST.

△ - STREETS & ALLEYS CLOSED PER ORD. #02-287; 2/15/02

NOTICE
 THIS IS A REAL PROPERTY PLAT AS PROVIDED FOR UNDER ARTICLE 76(d) OF THE CITY CHARTER. IT IS COMPILED FROM TITLE AND OTHER SOURCES AND IS NOT AN AUTHENTIC SURVEY.

CITY OF BALTIMORE
 DEPARTMENT OF PUBLIC WORKS
 BUREAU OF PLANS & SURVEYS
 PROPERTY LOCATION DIVISION
 WARD 8 SECTION 11
 BLOCK 1533
 SCALE 1 INCH = 50 FT. DATE April 1929

TRACED BY R. LITZ
 LETTERED BY Jos. J. Rokosky
 CHECKED BY R. LITZ
 W.R. - BAIN