

REVISIONS

Lot 92 Ho. No. Per P.L.D in field C. Sh 7942A
 LOTS 44 & 45 CH. PER D. OF A.; C. SH. 9430.
 LOTS 90 & 91 CONS'D PER APP.; C. SH. 333
 LOT 67/68 DIV PER DEED C. SH. 86-139
 LOTS 69-78 CONS'D PER D. OF A.; CH. SH. 21-016

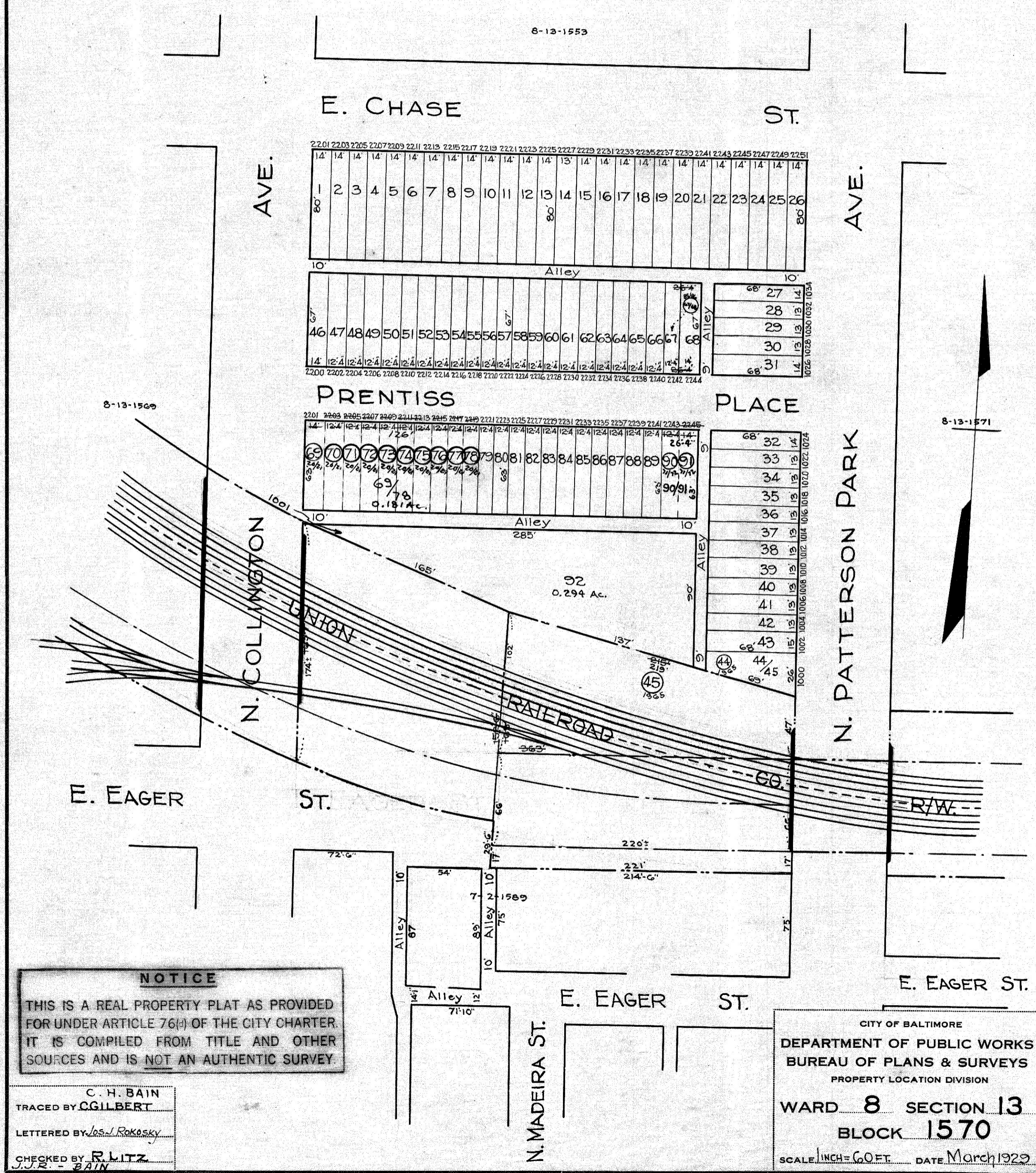

NOTICE
 THIS IS A REAL PROPERTY PLAT AS PROVIDED FOR UNDER ARTICLE 76(d) OF THE CITY CHARTER. IT IS COMPILED FROM TITLE AND OTHER SOURCES AND IS NOT AN AUTHENTIC SURVEY.

C. H. BAIN
 TRACED BY C. GILBERT
 LETTERED BY J. S. Rakosky
 CHECKED BY R. LITZ
 J. R. - BAIN

CITY OF BALTIMORE
 DEPARTMENT OF PUBLIC WORKS
 BUREAU OF PLANS & SURVEYS
 PROPERTY LOCATION DIVISION
 WARD 8 SECTION 13
 BLOCK 1570
 SCALE 1 INCH = 60 FEET DATE March 1929