

REVISIONS
 Lot 42 Ho. No. Per P.L.D.C. Sh. 6322 A

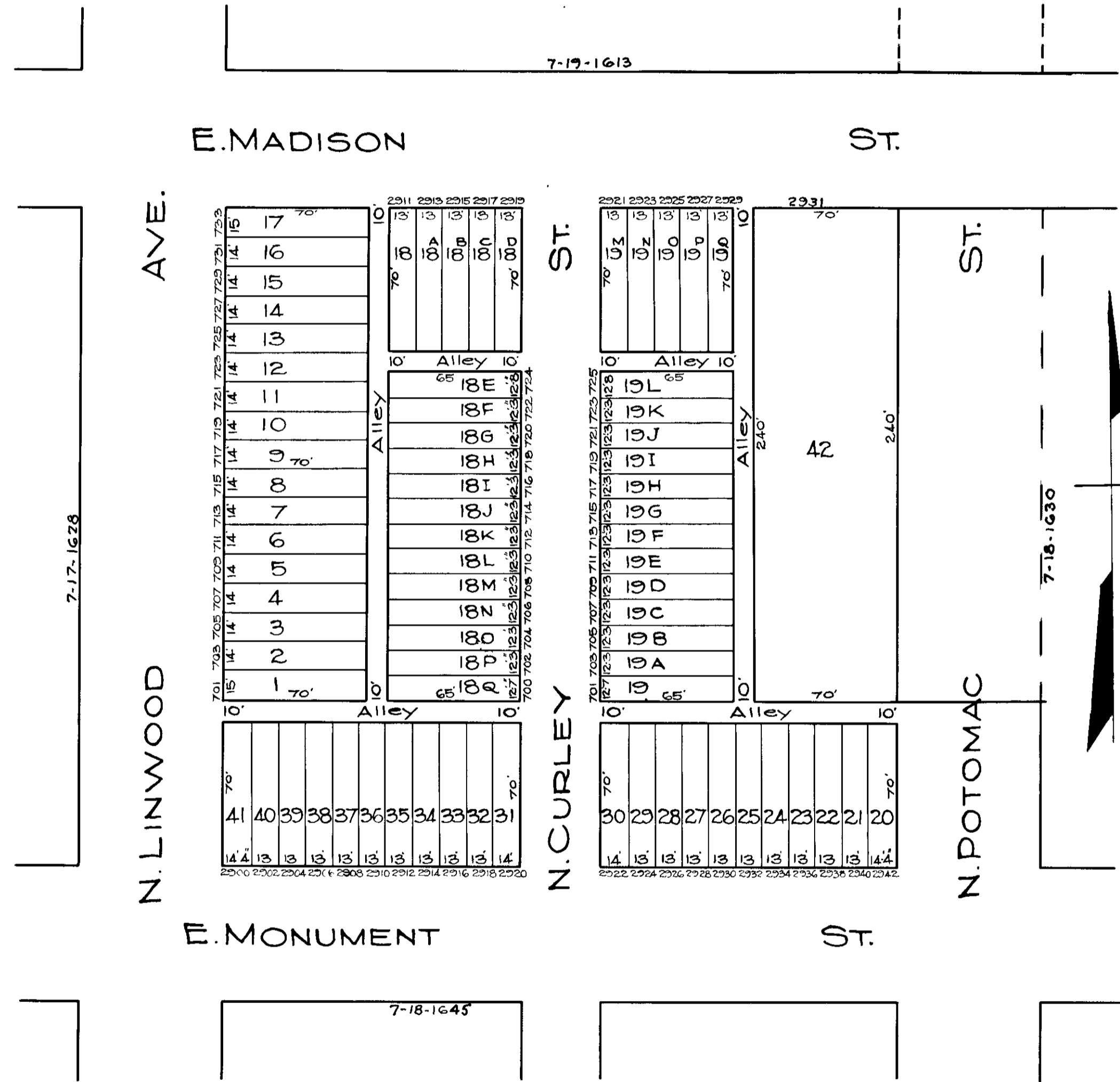

NOTE: BLOCK 7-17-1629 FOR 1940.

G BAUERSFELD
 TRACED BY C. GILBERT
 LETTERED BY JAS. J. ROZANSKY
 CHECKED BY W. M. LEE
 R. LITZ - BAIN

NOTICE
 THIS IS A REAL PROPERTY PLAT AS PROVIDED
 FOR UNDER ARTICLE 76 OF THE CITY CHARTER.
 IT IS COMPILED FROM TITLE AND OTHER
 SOURCES AND IS NOT AN AUTHENTIC SURVEY

CITY OF BALTIMORE
 DEPARTMENT OF PUBLIC WORKS
 BUREAU OF PLANS & SURVEYS
 PROPERTY LOCATION DIVISION
 WARD 7 SECTION 18
 BLOCK 1629
 SCALE 1 INCH = 50 FEET DATE April 1929