

REVISIONS

LOTS 5 & 6 CONS'D PER O.O. C.S.H. 83-192
 LOTS 7 & 10 PER, D.O.F.L., C.S.H. 86-313
 LOT 1/4 & 58A CONS'D. PER DEED & P.L.S.; C.S.H. 87-178.
 LOTS 65 & 71 PER DEED & D.O.F.L., C.S.H. 88-279
 LOTS 5/6-12, 20-21, 25, 27A, 58, 68-68B, 70, 77/78, 81A, & 92-94 PER DEED'S, C.S.H. 89-206-208

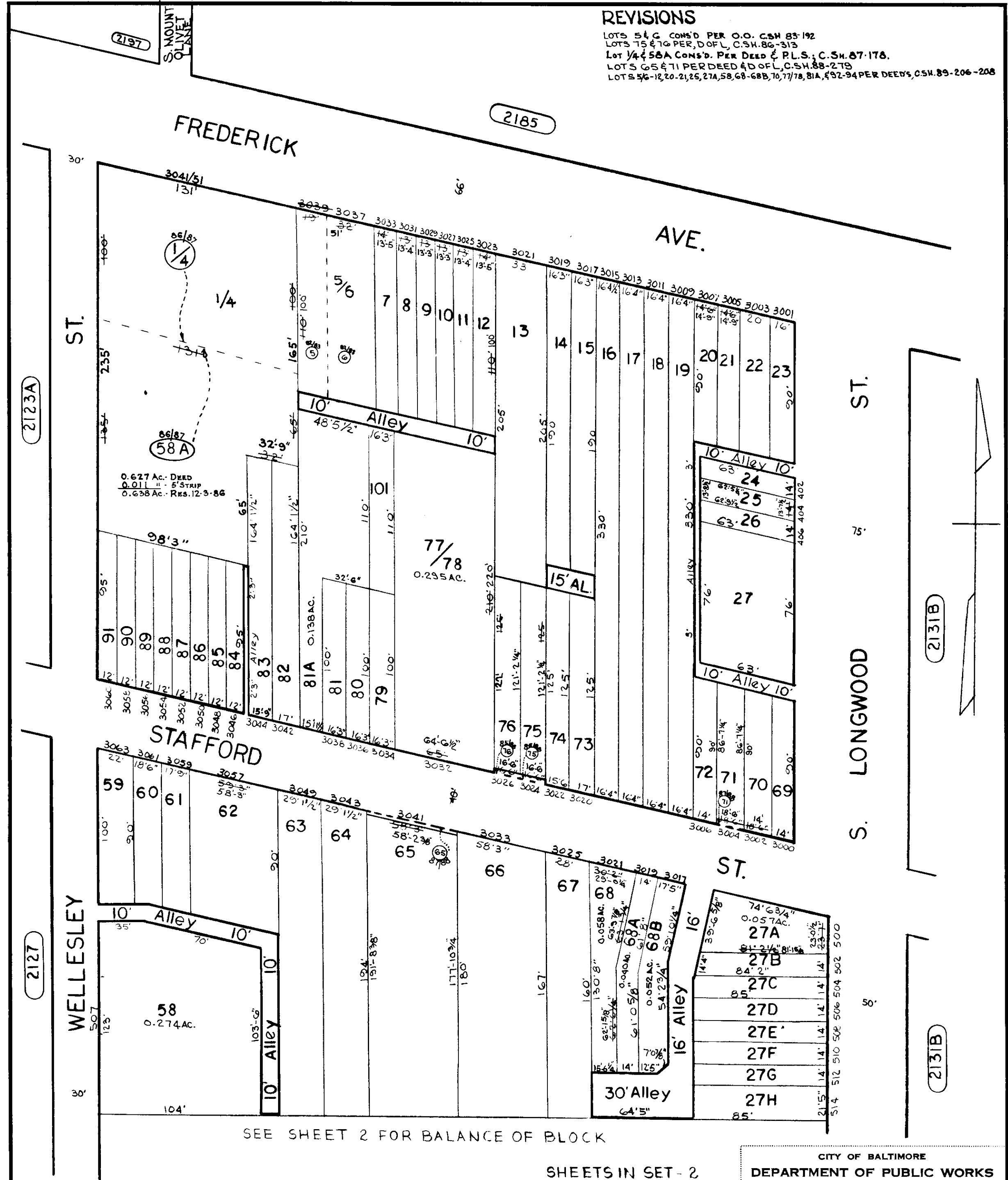

SEE SHEET 2 FOR BALANCE OF BLOCK

SHEETS IN SET - 2
 SHEET 1

NOTICE

THIS IS A REAL PROPERTY PLAT AS PROVIDED FOR UNDER ARTICLE 76(d) OF THE CITY CHARTER IT IS COMPILED FROM TITLE AND OTHER SOURCES AND IS NOT AN AUTHENTIC SURVEY.

CITY OF BALTIMORE
 DEPARTMENT OF PUBLIC WORKS

PROPERTY LOCATION DIVISION

WARD 20 SECTION 5
 BLOCK 2123B

SCALE 1" = 50' DATE MAY 1967

TRACED BY R. KLAGES
 LETTERED BY R. K.
 CHECKED BY

REVISIONS

LOT 55 HO. NO. PER. APPL. C. 54. 87-013
 LOTS 56-12, 20-21, 25, 27A, 58, 68-68B, 70, 77, 78, 81A & 92-94 PER DEED'S, C. 54. 89-204-208

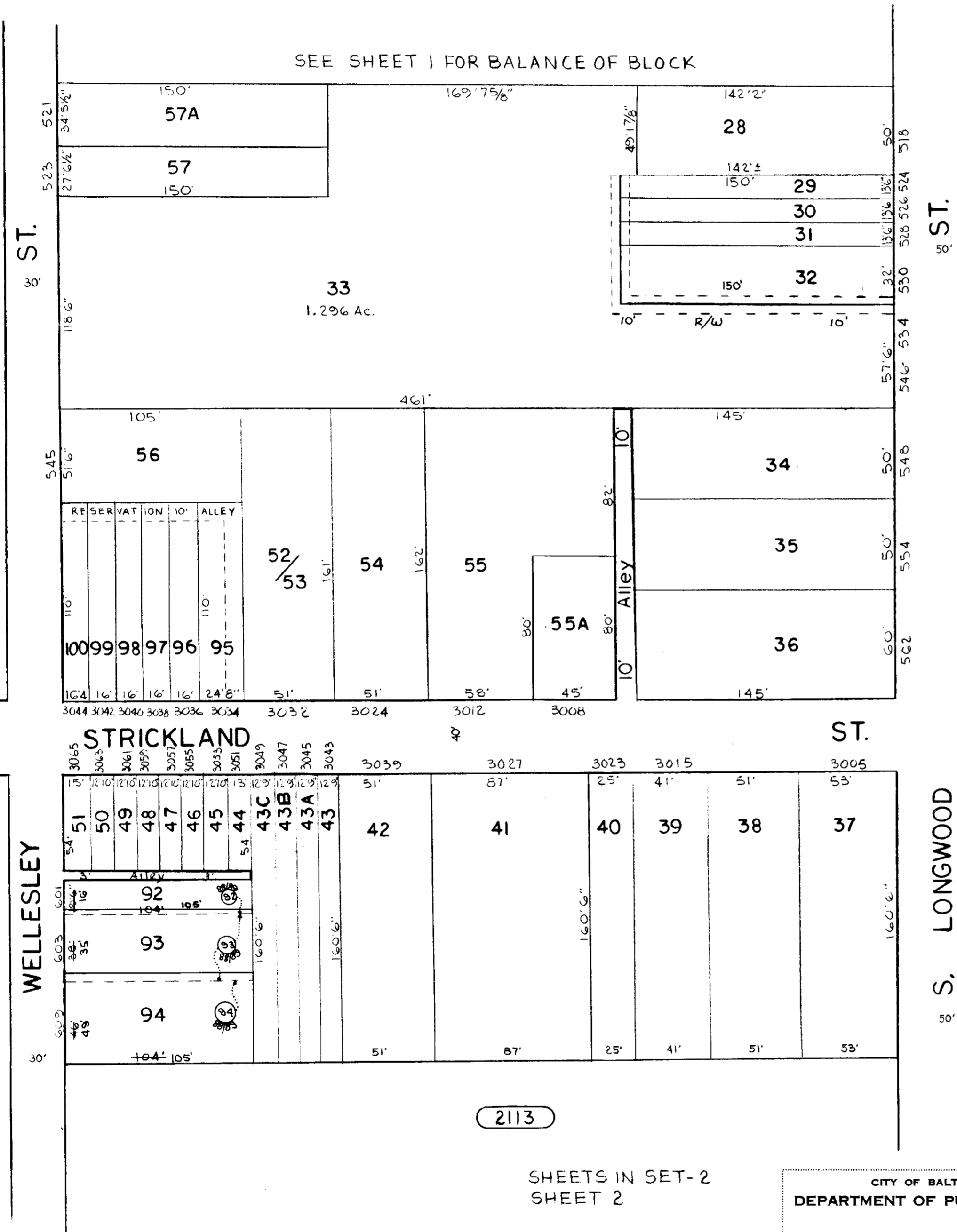

SEE SHEET 1 FOR BALANCE OF BLOCK

2127

2131B

2113

2131B

2113

SHEETS IN SET-2
 SHEET 2

NOTICE

THIS IS A REAL PROPERTY PLAT AS PROVIDED FOR UNDER ARTICLE 76(d) OF THE CITY CHARTER IT IS COMPILED FROM TITLE AND OTHER SOURCES AND IS NOT AN AUTHENTIC SURVEY.

CITY OF BALTIMORE
 DEPARTMENT OF PUBLIC WORKS

PROPERTY LOCATION DIVISION
WARD 20 SECTION 5
BLOCK 2123B

SCALE 1" = 50' DATE MAY 1967

TRACED BY R. KLAGES

LETTERED BY R. K.

CHECKED BY