

REVISIONS
 Dim Lots 8-14 by possession, per Hal' C Sh. 808.
 Lot 33/33A Divided For 1937 Per O & B of A.C.S.H. 2047.

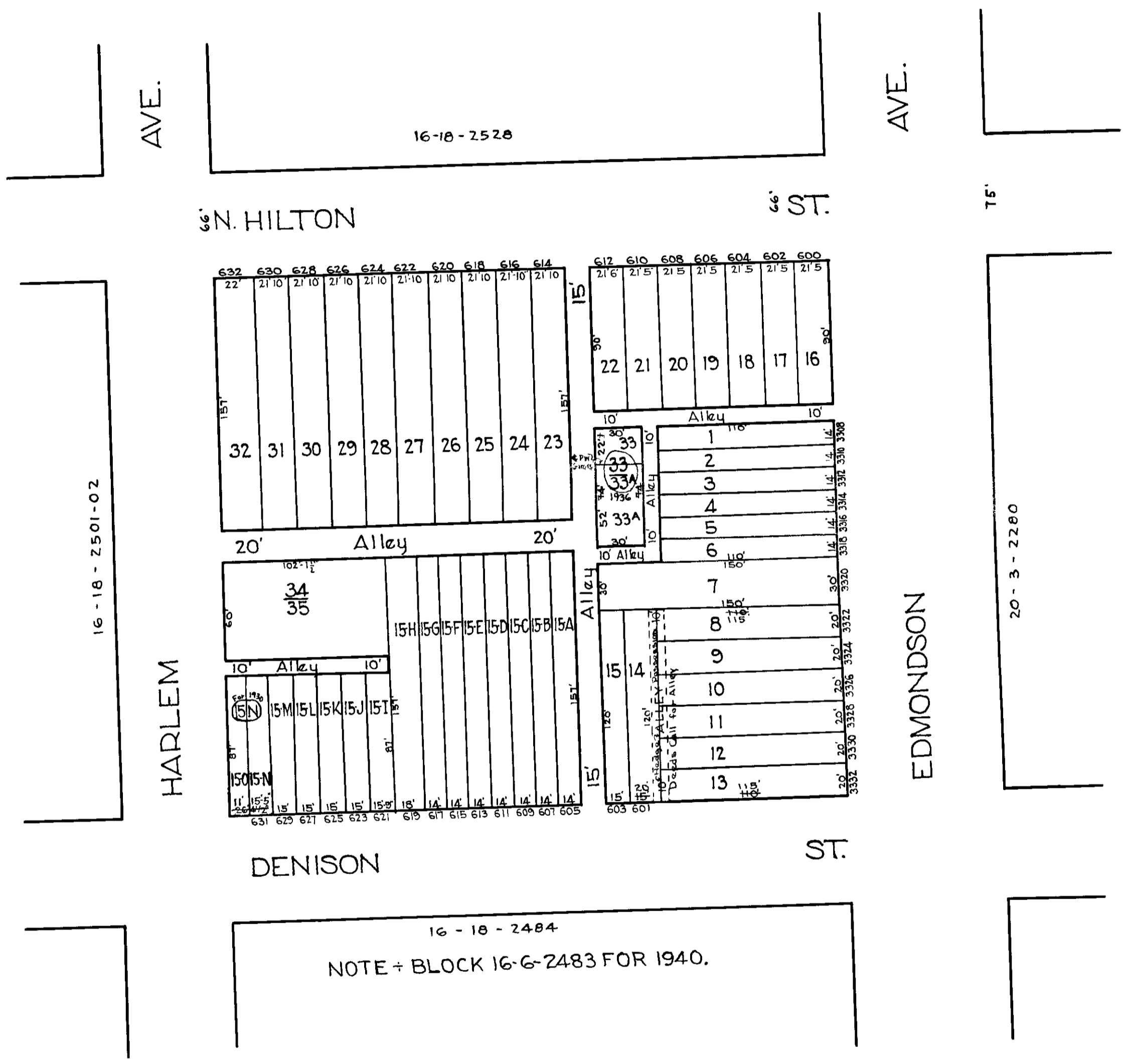
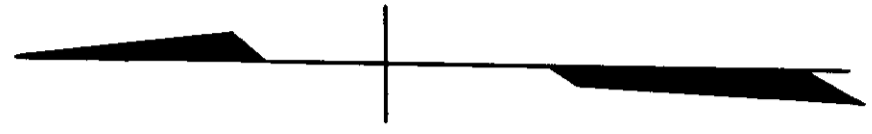

TRACED BY C.G. Miller
 LETTERED BY H.V. Housler
 CHECKED BY

NOTICE
 THIS IS A REAL PROPERTY PLAT AS PROVIDED
 FOR UNDER ARTICLE 76(e) OF THE CITY CHARTER.
 IT IS COMPILED FROM TITLE AND OTHER
 SOURCES AND IS NOT AN AUTHENTIC SURVEY

CITY OF BALTIMORE
 DEPARTMENT OF PUBLIC WORKS
 BUREAU OF PLANS & SURVEYS
 PROPERTY LOCATION DIVISION
 WARD 16 SECTION 18
 BLOCK 2483
 SCALE: 1"=60'-0" DATE: March 1930