

**REVISIONS**  
 LOT 25 PER P.L.S. C.S.H. 246.  
 Lots 3-6 Cor Per P.L.S. 2 Dead Pac; C.S.H. 87-166.

DENISON ST.

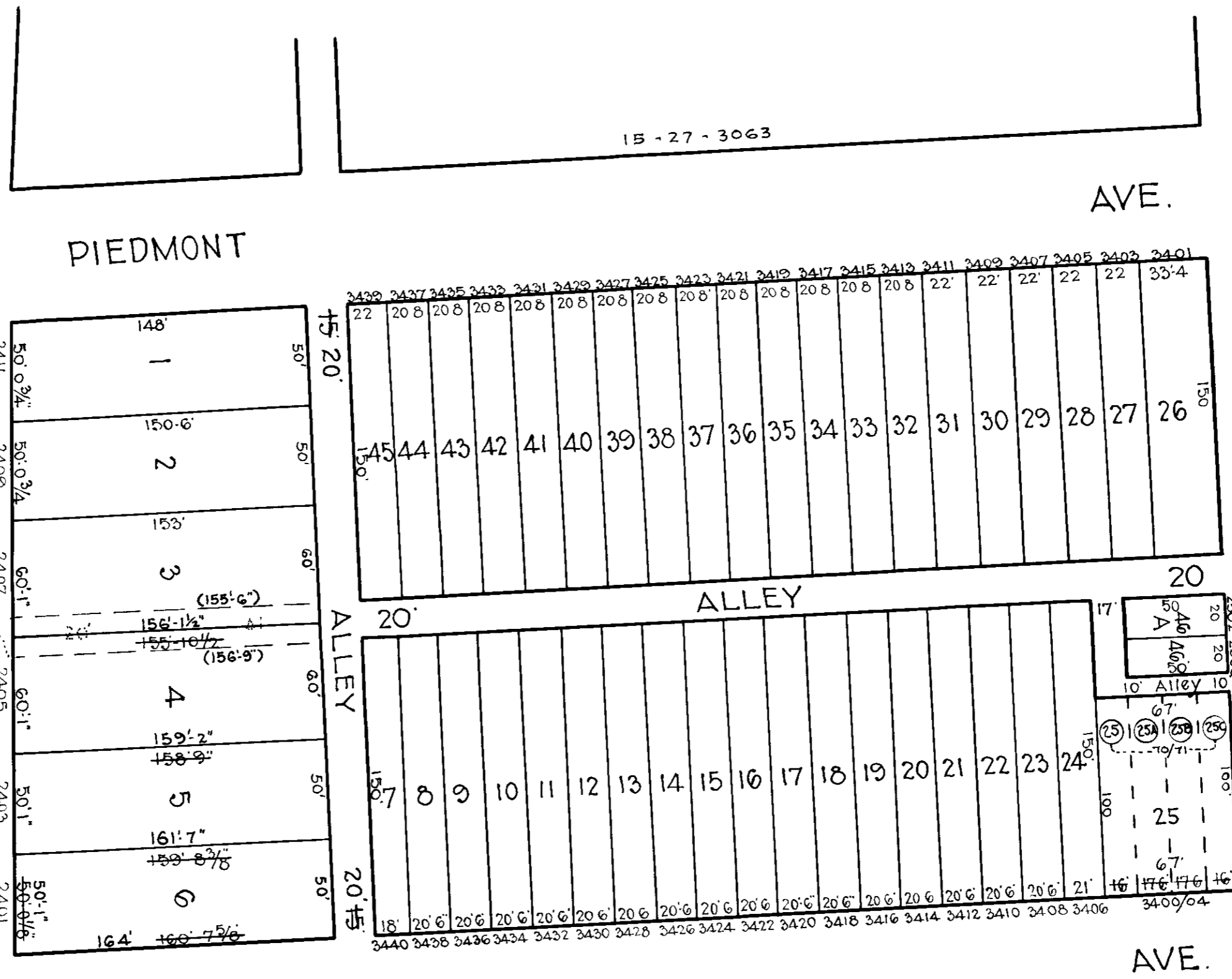

**NOTICE**

THIS IS A REAL PROPERTY PLAT AS PROVIDED FOR UNDER ARTICLE 76(d) OF THE CITY CHARTER. IT IS COMPILED FROM TITLE AND OTHER SOURCES AND IS NOT AN AUTHENTIC SURVEY.

15 - 28 - 2823 - A

NOTE: BLOCK 15-2-3058 FOR 1940.

TRACED BY **L.S. Bell**  
 LETTERED BY **W.M.L.**  
 CHECKED BY

CITY OF BALTIMORE  
 DEPARTMENT OF PUBLIC WORKS  
 BUREAU OF PLANS & SURVEYS  
 PROPERTY LOCATION DIVISION

WARD **15** SECTION **27**  
 BLOCK **3058**

SCALE: 1" = 60'-0" DATE Feb. 1930