

REVISIONS
 LOTS 17, 18, 19, 20 CONS'D PERLO.O./CH. S# 12-268

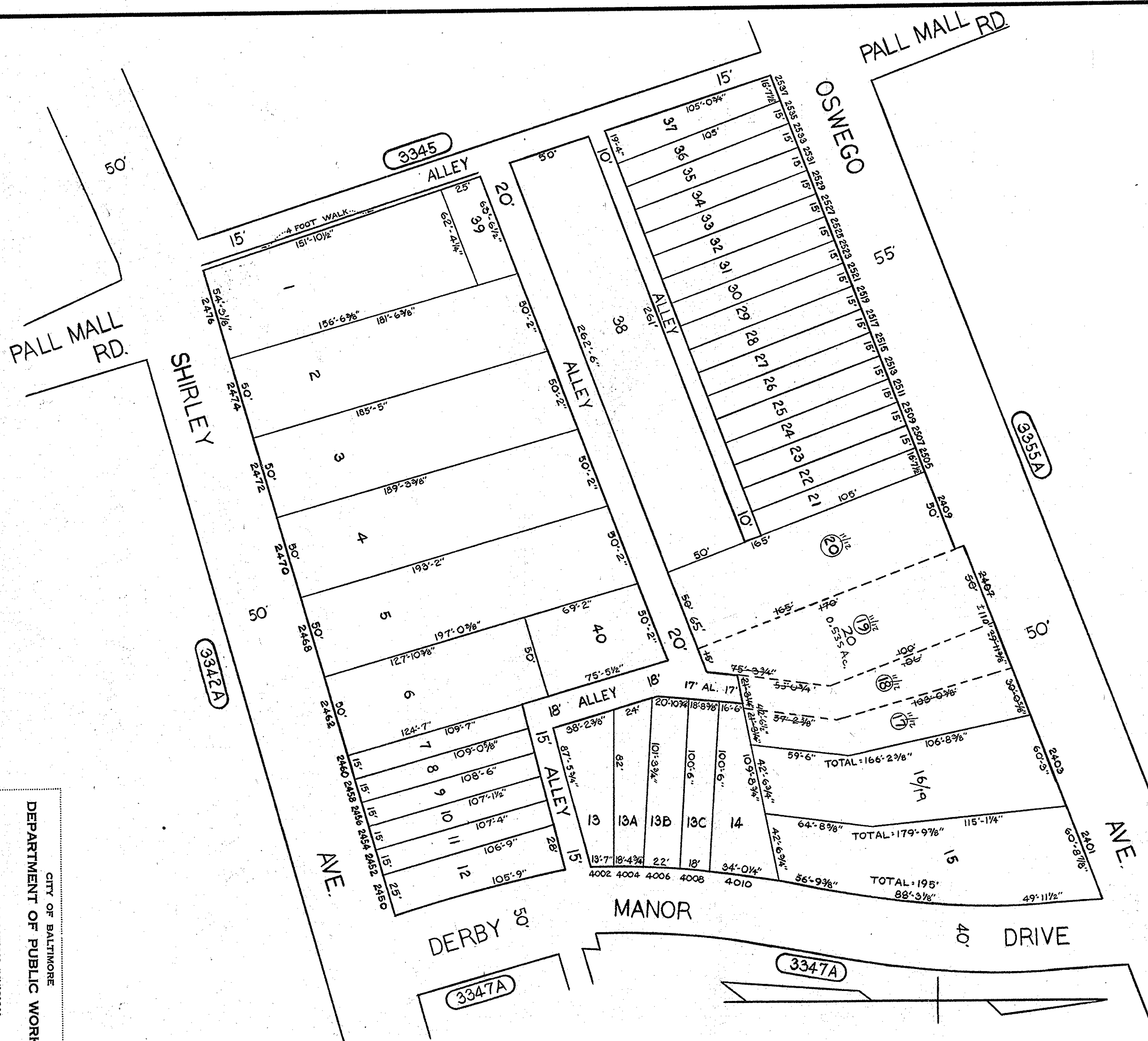

TRACED BY: I. BALDUCCI
 LETTERED BY: I. BALDUCCI
 CHECKED BY:

NOTICE
 THIS IS A REAL PROPERTY PLAT AS PROVIDED FOR UNDER ARTICLE 76(d) OF THE CITY CHARTER. IT IS COMPILED FROM TITLE AND OTHER SOURCES AND IS NOT AN AUTHENTIC SURVEY.

CITY OF BALTIMORE
 DEPARTMENT OF PUBLIC WORKS
 PROPERTY LOCATION DIVISION
WARD 15 SECTION 33
BLOCK 3347
 SCALE: 1/4" = 50 FT. DATE: MAR. 1968