

NEWINGTON

AVE.

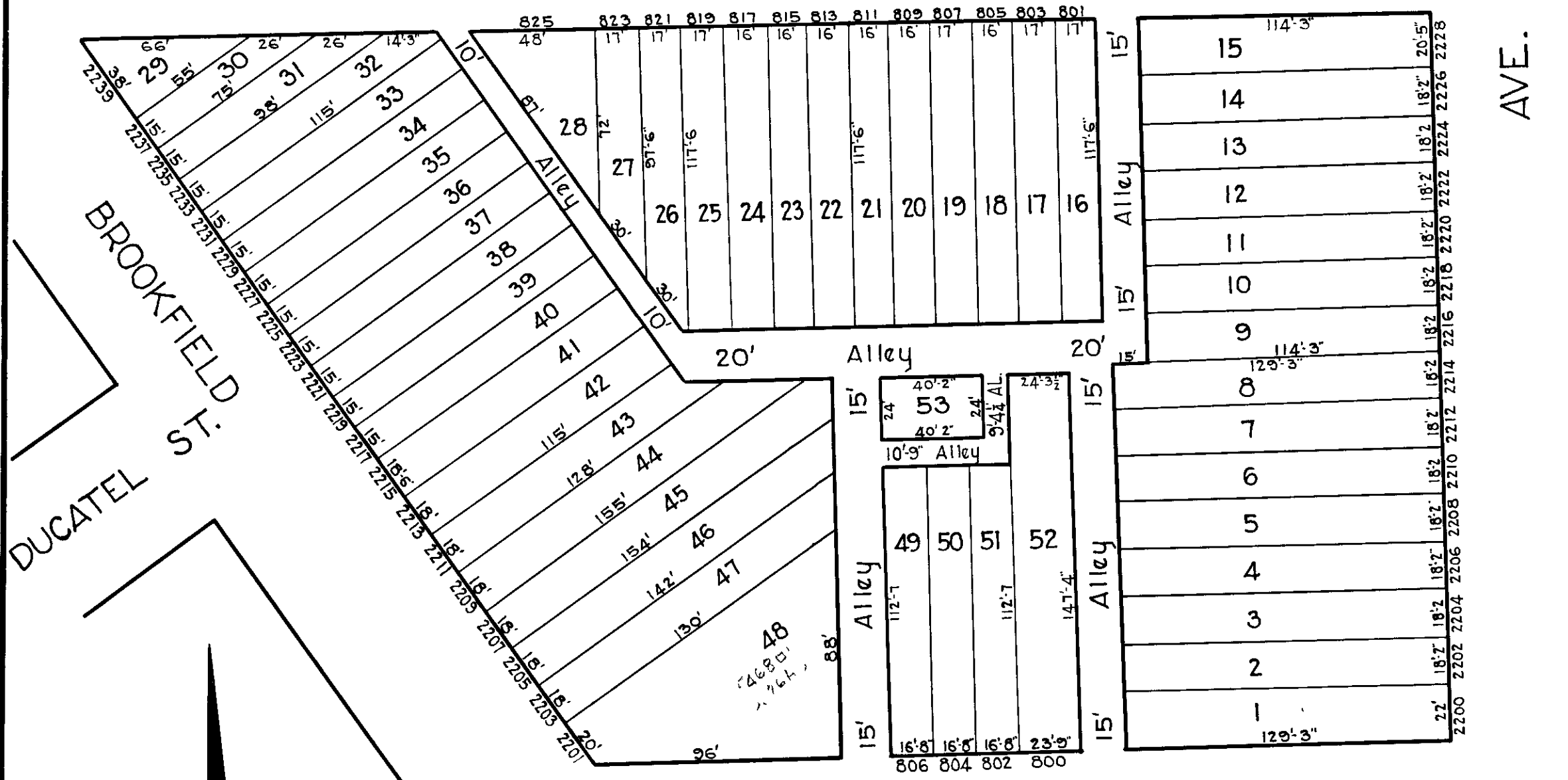

TRACED BY C. H. BAIN.  
 LETTERED BY H. V. HOUSEL.  
 CHECKED BY \_\_\_\_\_

**NOTICE**  
 THIS IS A REAL PROPERTY PLAT AS PROVIDED FOR UNDER ARTICLE 76(d) OF THE CITY CHARTER. IT IS COMPILED FROM TITLE AND OTHER SOURCES AND IS NOT AN AUTHENTIC SURVEY

CITY OF BALTIMORE  
 DEPARTMENT OF PUBLIC WORKS  
 BUREAU OF PLANS & SURVEYS  
 PROPERTY LOCATION DIVISION  
 WARD 13 SECTION 10  
 BLOCK 3445  
 SCALE: 1" = 50'-0" DATE DEC. 1929