

REVISIONS
 LOTS 2, 3/5, 12/13 & 14 PER DEED, C.S.H. 90-217

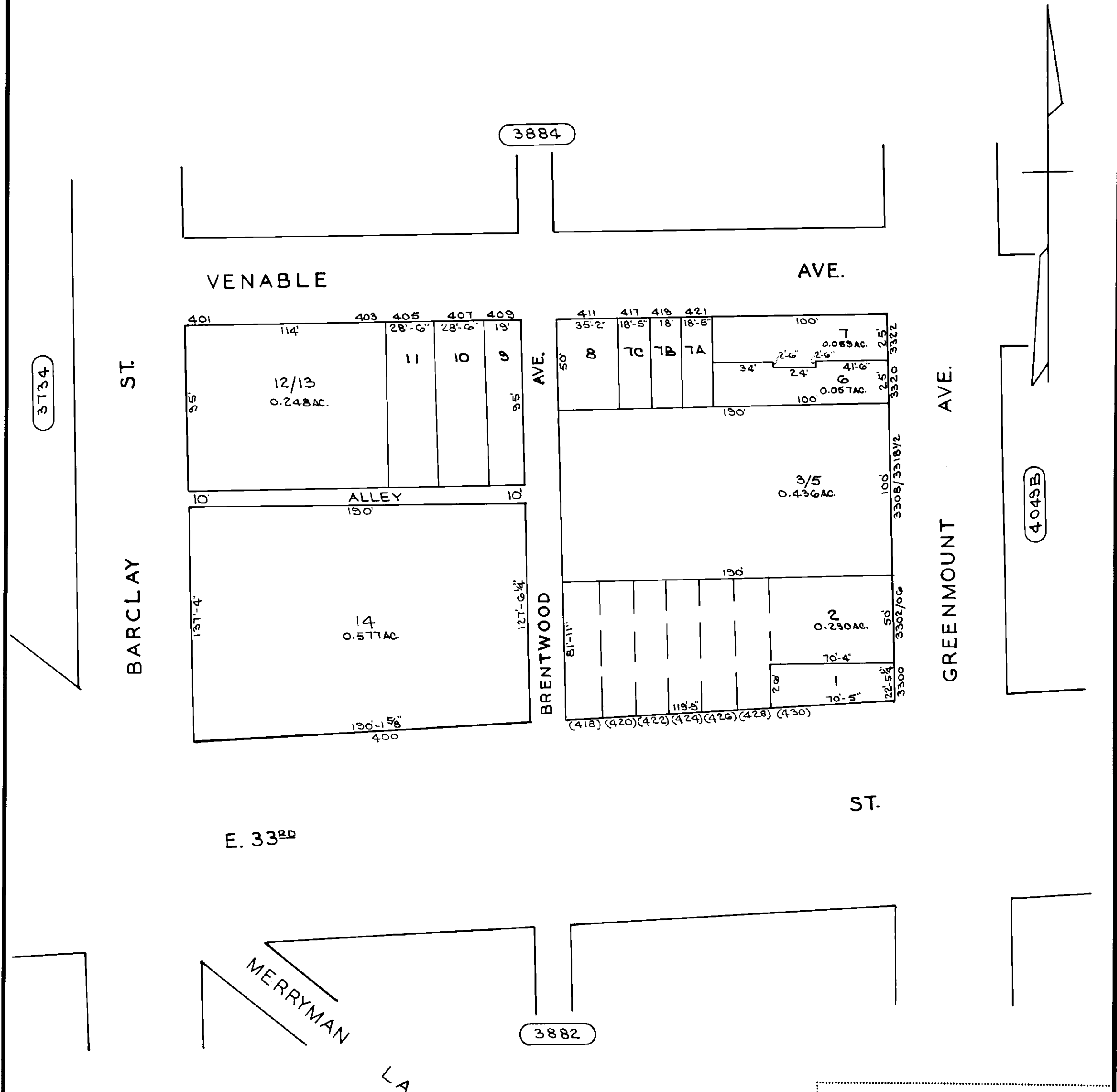

TRACED BY D.G.
 LETTERED BY D.G.
 CHECKED BY

NOTICE
 THIS IS A REAL PROPERTY PLAT AS PROVIDED FOR UNDER ARTICLE 76(d) OF THE CITY CHARTER IT IS COMPILED FROM TITLE AND OTHER SOURCES AND IS NOT AN AUTHENTIC SURVEY.

CITY OF BALTIMORE
 DEPARTMENT OF PUBLIC WORKS
 PROPERTY LOCATION SECTION
 WARD 12 SECTION 18
 BLOCK 3883
 SCALE 1"=50' DATE MARCH 1990