

REVISIONS  
Lot 8 DIVIDED PER DEED C.Sh. 1549.  
Lot 8B per App. 3098 C.Sh. 1854  
Lot 8A Corrected Per Deed C.Sh. 1955A

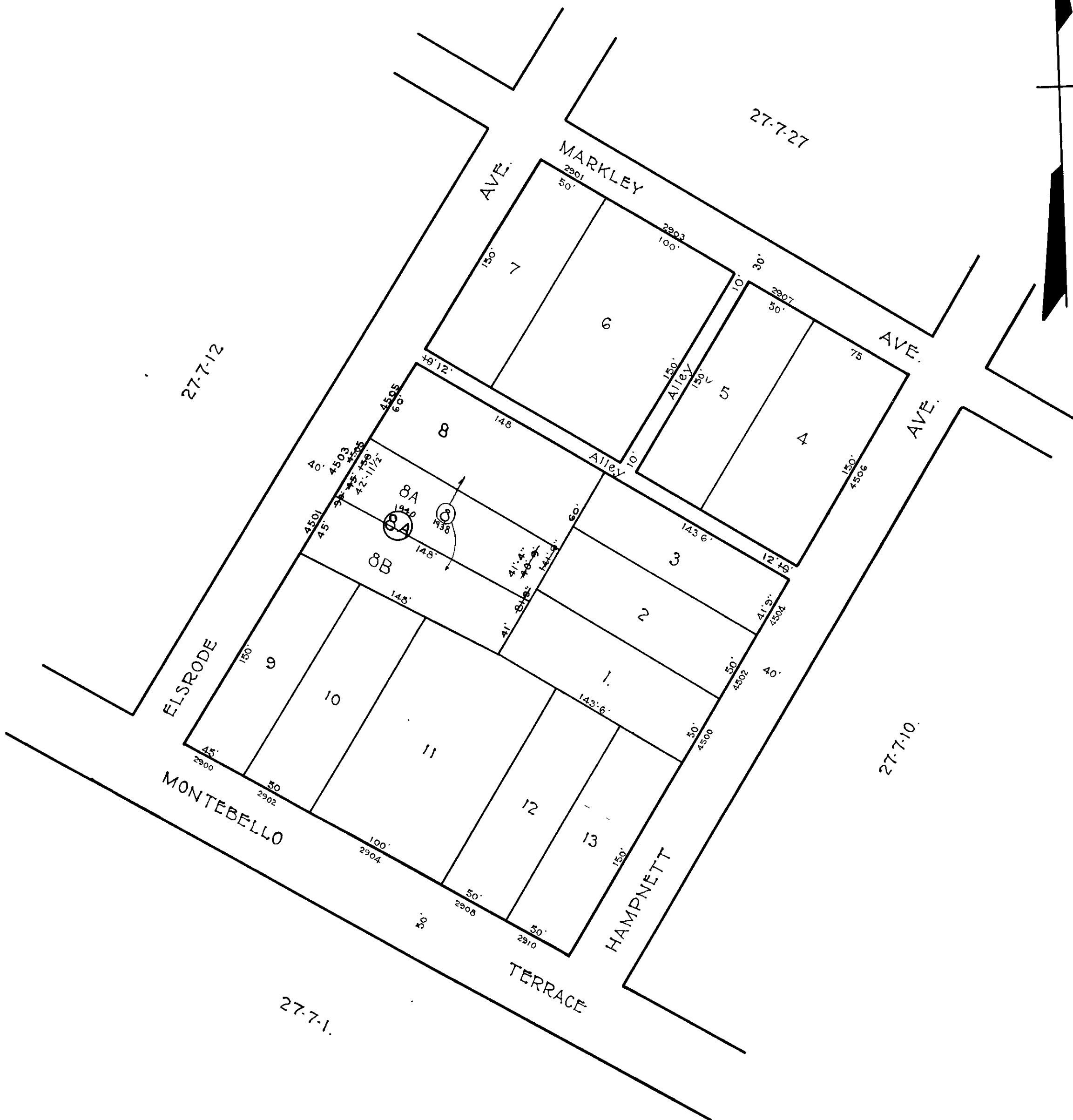

NOTICE

THIS IS A REAL PROPERTY PLAT AS PROVIDED  
FOR UNDER ARTICLE 76(4) OF THE CITY CHARTER.  
IT IS COMPILED FROM TITLE AND OTHER  
SOURCES AND IS NOT AN AUTHENTIC SURVEY.

NOTE - Block 27-7-11 For 1941.

TRACED BY M.C. STUMPF.

LETTERED BY W.M.L.

CHECKED BY

5345

CITY OF BALTIMORE  
DEPARTMENT OF PUBLIC WORKS  
BUREAU OF PLANS & SURVEYS  
PROPERTY LOCATION DIVISION

WARD 27 SECTION 7  
BLOCK 5345

SCALE 1" = 60' 0" DATE Sept. 1931.