

REVISIONS

LOTS 65 TO 119, SECT. CHANGED PER P.L.D.C.S. 8063

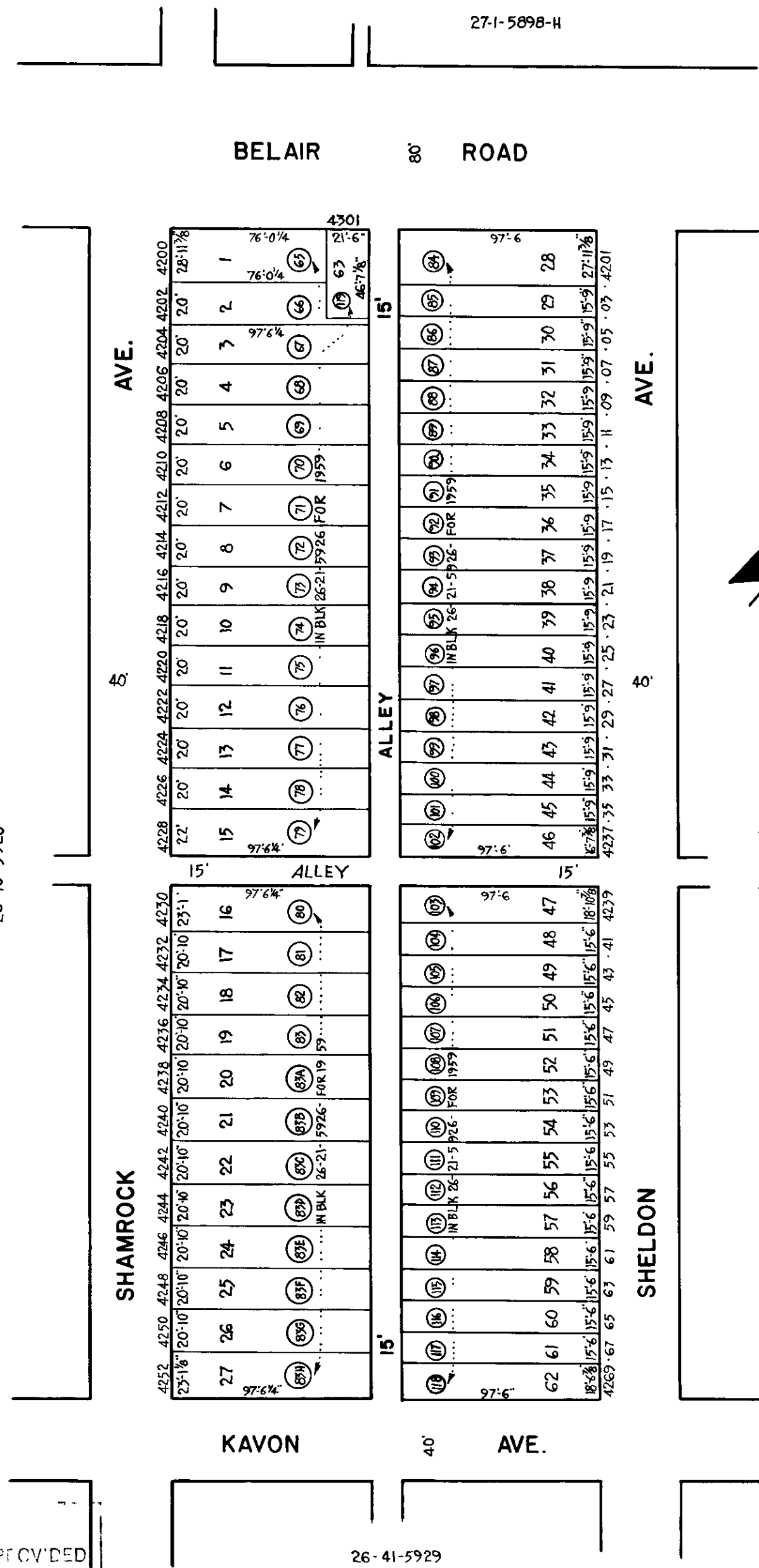

NOTICE
 THIS IS A REAL PROPERTY PLAT AS PROVIDED FOR UNDER ARTICLE 76(1) OF THE CITY CHARTER. IT IS COMPILED FROM TITLE AND OTHER SOURCES AND IS NOT AN AUTHENTIC SURVEY.

TRACED BY *S. H. Pinner*
 LETTERED BY *S. C. Pinner*
 CHECKED BY

NOTE · BLOCK 26-21-5926 FOR 1959 LOT 65 ETC.

CITY OF BALTIMORE
 DEPARTMENT OF PUBLIC WORKS
 BUREAU OF SURVEYS
 PROPERTY LOCATION DIVISION
 WARD 26 SECTION 40
 BLOCK 5928
 SCALE 1" = 60' DATE JAN. 1959